

Fitting Series

$\phi 4$, $\phi 6$, $\phi 8$, $\phi 10$, $\phi 12$

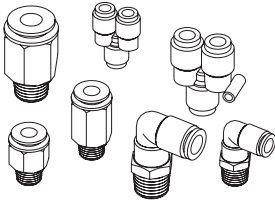

Specification

Max pressure	MPa (bar)	1.2 (12.0)
Pressure range		0.99 (9.9)
Temperature range	°C	5~60
Fluid		Air, Water
Material		Nylon, Polyuretans
Port size		M5, 1/8, 1/4, 3/8, 1/2
Tube OD	mm	$\phi 4$, $\phi 6$, $\phi 8$, $\phi 10$, $\phi 12$

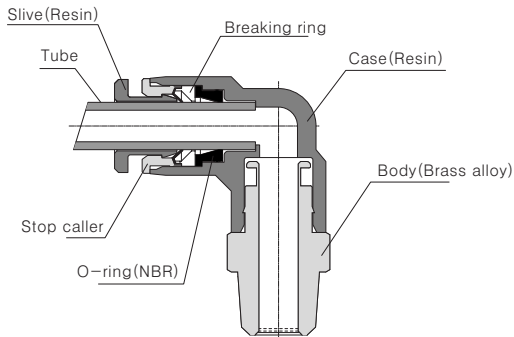

Fitting Series

Kind of Connector

kind of connector	Model	port size	Apply tube (φ)				
			4	6	8	10	12
Male	FSC	M5	<input type="checkbox"/>	<input type="checkbox"/>			
		1/8	<input type="checkbox"/>	<input type="checkbox"/>	<input type="checkbox"/>	<input type="checkbox"/>	
		1/4	<input type="checkbox"/>	<input type="checkbox"/>	<input type="checkbox"/>	<input type="checkbox"/>	<input type="checkbox"/>
		3/8			<input type="checkbox"/>	<input type="checkbox"/>	<input type="checkbox"/>
		1/2			<input type="checkbox"/>	<input type="checkbox"/>	<input type="checkbox"/>
Male	FSCL	M5	<input type="checkbox"/>	<input type="checkbox"/>			
		1/8	<input type="checkbox"/>	<input type="checkbox"/>	<input type="checkbox"/>	<input type="checkbox"/>	
		1/4	<input type="checkbox"/>	<input type="checkbox"/>	<input type="checkbox"/>	<input type="checkbox"/>	<input type="checkbox"/>
		3/8			<input type="checkbox"/>	<input type="checkbox"/>	<input type="checkbox"/>
		1/2			<input type="checkbox"/>	<input type="checkbox"/>	<input type="checkbox"/>
Male elbow	FSE	M5	<input type="checkbox"/>	<input type="checkbox"/>			
		1/8	<input type="checkbox"/>	<input type="checkbox"/>	<input type="checkbox"/>	<input type="checkbox"/>	
		1/4	<input type="checkbox"/>	<input type="checkbox"/>	<input type="checkbox"/>	<input type="checkbox"/>	<input type="checkbox"/>
		3/8		<input type="checkbox"/>	<input type="checkbox"/>	<input type="checkbox"/>	<input type="checkbox"/>
		1/2			<input type="checkbox"/>	<input type="checkbox"/>	<input type="checkbox"/>
Long elbow	FLE	M5	<input type="checkbox"/>	<input type="checkbox"/>			
		1/8	<input type="checkbox"/>	<input type="checkbox"/>	<input type="checkbox"/>	<input type="checkbox"/>	
		1/4	<input type="checkbox"/>	<input type="checkbox"/>	<input type="checkbox"/>	<input type="checkbox"/>	<input type="checkbox"/>
		3/8		<input type="checkbox"/>	<input type="checkbox"/>	<input type="checkbox"/>	<input type="checkbox"/>
		1/2			<input type="checkbox"/>	<input type="checkbox"/>	<input type="checkbox"/>
Female	FSF	1/8	<input type="checkbox"/>	<input type="checkbox"/>	<input type="checkbox"/>	<input type="checkbox"/>	
		1/4	<input type="checkbox"/>	<input type="checkbox"/>	<input type="checkbox"/>	<input type="checkbox"/>	<input type="checkbox"/>
		3/8			<input type="checkbox"/>	<input type="checkbox"/>	<input type="checkbox"/>
		1/2					<input type="checkbox"/>
Female	FSFP	1/8	<input type="checkbox"/>	<input type="checkbox"/>	<input type="checkbox"/>	<input type="checkbox"/>	
		1/4	<input type="checkbox"/>	<input type="checkbox"/>	<input type="checkbox"/>	<input type="checkbox"/>	<input type="checkbox"/>
		3/8			<input type="checkbox"/>	<input type="checkbox"/>	<input type="checkbox"/>
		1/2					<input type="checkbox"/>
Male branch tee swivel	FST	M5	<input type="checkbox"/>	<input type="checkbox"/>	<input type="checkbox"/>		
		1/8	<input type="checkbox"/>	<input type="checkbox"/>	<input type="checkbox"/>	<input type="checkbox"/>	
		1/4	<input type="checkbox"/>	<input type="checkbox"/>	<input type="checkbox"/>	<input type="checkbox"/>	<input type="checkbox"/>
		3/8		<input type="checkbox"/>	<input type="checkbox"/>	<input type="checkbox"/>	<input type="checkbox"/>
		1/2			<input type="checkbox"/>	<input type="checkbox"/>	<input type="checkbox"/>
Male branch tee swivel	FSTL	M5	<input type="checkbox"/>	<input type="checkbox"/>	<input type="checkbox"/>		
		1/8	<input type="checkbox"/>	<input type="checkbox"/>	<input type="checkbox"/>	<input type="checkbox"/>	
		1/4	<input type="checkbox"/>	<input type="checkbox"/>	<input type="checkbox"/>	<input type="checkbox"/>	<input type="checkbox"/>
		3/8		<input type="checkbox"/>	<input type="checkbox"/>	<input type="checkbox"/>	<input type="checkbox"/>
Bulkhead equal union	FSB	–	<input type="checkbox"/>	<input type="checkbox"/>	<input type="checkbox"/>	<input type="checkbox"/>	<input type="checkbox"/>

kind of connector	Model	port size	Apply tube (φ)				
			4	6	8	10	12
Union Y male	FSY	M5	<input type="checkbox"/>	<input type="checkbox"/>			
		1/8	<input type="checkbox"/>	<input type="checkbox"/>	<input type="checkbox"/>	<input type="checkbox"/>	
		1/4	<input type="checkbox"/>	<input type="checkbox"/>	<input type="checkbox"/>	<input type="checkbox"/>	<input type="checkbox"/>
		3/8		<input type="checkbox"/>	<input type="checkbox"/>	<input type="checkbox"/>	<input type="checkbox"/>
		1/2			<input type="checkbox"/>	<input type="checkbox"/>	<input type="checkbox"/>
Male elbow	FSES	M5	<input type="checkbox"/>	<input type="checkbox"/>			
		1/8	<input type="checkbox"/>	<input type="checkbox"/>			
		1/4		<input type="checkbox"/>	<input type="checkbox"/>	<input type="checkbox"/>	
		3/8			<input type="checkbox"/>	<input type="checkbox"/>	<input type="checkbox"/>
		1/2				<input type="checkbox"/>	<input type="checkbox"/>
Union cross	FUC	–	<input type="checkbox"/>	<input type="checkbox"/>	<input type="checkbox"/>	<input type="checkbox"/>	<input type="checkbox"/>
Plyg-in Y elbow	FEY	–	<input type="checkbox"/>	<input type="checkbox"/>	<input type="checkbox"/>	<input type="checkbox"/>	<input type="checkbox"/>
Plyg-in elbow	FEP		<input type="checkbox"/>	<input type="checkbox"/>	<input type="checkbox"/>	<input type="checkbox"/>	<input type="checkbox"/>
Plyg-in Y	FEYR	06	<input type="checkbox"/>				
		08		<input type="checkbox"/>			
		10			<input type="checkbox"/>		
Equal union reducer	FUER	12				<input type="checkbox"/>	
		06	<input type="checkbox"/>				
		08		<input type="checkbox"/>			
Union Y reducer	FUJR	10			<input type="checkbox"/>		
		12				<input type="checkbox"/>	
		06	<input type="checkbox"/>				
Union manifold	FUM	08		<input type="checkbox"/>			
		φ 4		<input type="checkbox"/>	<input type="checkbox"/>		
		φ 6			<input type="checkbox"/>	<input type="checkbox"/>	
Union manifold	FUMC	φ 8				<input type="checkbox"/>	
		1/8(φ4)		<input type="checkbox"/>			
		1/4(φ4)			<input type="checkbox"/>		
		1/4(φ6)			<input type="checkbox"/>		
Union manifold	FURL	3/8(φ8)				<input type="checkbox"/>	
		φ 4		<input type="checkbox"/>	<input type="checkbox"/>		
		φ 6			<input type="checkbox"/>		
Union manifold	FURL	φ 8				<input type="checkbox"/>	
		–	<input type="checkbox"/>	<input type="checkbox"/>	<input type="checkbox"/>	<input type="checkbox"/>	<input type="checkbox"/>
Union	FUT	–	<input type="checkbox"/>	<input type="checkbox"/>	<input type="checkbox"/>	<input type="checkbox"/>	<input type="checkbox"/>
Union Y	FUY	–	<input type="checkbox"/>	<input type="checkbox"/>	<input type="checkbox"/>	<input type="checkbox"/>	<input type="checkbox"/>
Equal union	FUE	–	<input type="checkbox"/>	<input type="checkbox"/>	<input type="checkbox"/>	<input type="checkbox"/>	<input type="checkbox"/>
Union elbow	FUL	–	<input type="checkbox"/>	<input type="checkbox"/>	<input type="checkbox"/>	<input type="checkbox"/>	<input type="checkbox"/>

Fitting Series

Female connector / FSFP

(unit : mm)

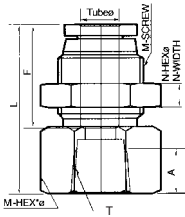

order code	Apply tybe dia. (φ)	T	L	N	M	A	HexN	Tube insert depth (F)	Hex
FSFP04-1/8	4	PT1/8	26.7	5	M12×1.0P	9	14×16.1	16.8	14×16.1
FSFP06-1/8	6	PT1/8	28.3	5	M14×1.0P	9	17×19.6	17.6	17×19.6
FSFP06-1/4	6	PT1/4	30.3	5	M14×1.0P	11	17×19.6	17.6	17×19.6
FSFP08-1/8	8	PT1/8	29.5	5	M16×1.0P	9	19×21.9	18.7	19×21.9
FSFP08-1/4	8	PT1/4	31.5	5	M16×1.0P	11	19×21.9	18.7	19×21.9
FSFP08-3/8	8	PT3/8	32.5	5	M16×1.0P	12	19×21.9	18.7	22×25.4
FSFP10-1/4	10	PT1/4	32.4	5	M20×1.0P	11	24×27.7	19.6	24×27.7
FSFP10-3/8	10	PT3/8	33.4	5	M20×1.0P	12	24×27.7	19.6	24×27.7
FSFP12-1/4	12	PT1/4	37.9	5	M22×1.0P	11	26×30.0	21.9	24×27.7
FSFP12-3/8	12	PT3/8	37.9	5	M22×1.0P	12	26×30.0	21.9	24×27.7
FSFP12-1/2	12	PT1/2	39.9	5	M22×1.0P	14	26×30.0	21.9	24×27.7

Bulkhead equal union / FSB

(unit : mm)

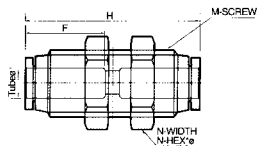

order code	Apply tybe dia. (φ)	H	Tube insert depth (F)	M	N- depth (N-Hex)
FSB04	4	29.8	16.3	M12×10P	5(14×16.1)
FSB06	6	33	17.6	M14×10P	5(17×19.6)
FSB08	8	35.4	18.7	M16×10P	5(19×21.9)
FSB10	10	37.8	19.6	M20×10P	5(24×27.7)
FSB12	12	47.4	21.9	M22×10P	5(26×30.0)

Male elbow swivel / FSE

(unit : mm)

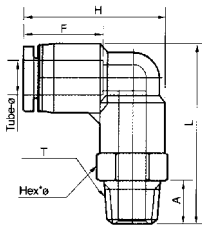

order code	Apply tybe dia. (φ)	T	L	H	Tube insert depth (F)	Hex
FSE04-M5	4	M5×0.8P	27.25	23.8	4.6	10×11.0
FSE04-1/8	4	PT1/8	29.75	23.8	8	10×11.0
FSE04-1/4	4	PT1/4	31.75	23.8	10	14×15.4
FSE06-M5	6	M5×0.8P	30.25	26.5	4.6	10×11.0
FSE06-1/8	6	PT1/8	32.75	26.5	8	12×13.0
FSE06-1/4	6	PT1/4	35.75	26.5	10	14×15.4
FSE06-3/8	6	PT3/8	36.75	26.5	11	17×18.5
FSE08-1/8	8	PT1/8	35.15	29.7	8	12×13.0
FSE08-1/4	8	PT1/4	38.15	29.7	10	14×15.4
FSE08-3/8	8	PT3/8	39.15	29.7	11	17×18.5
FSE08-1/2	8	PT1/2	42.15	29.7	14	22×24.5
FSE10-1/8	10	PT1/8	37.25	32.1	8	12×13.0
FSE10-1/4	10	PT1/4	40.25	32.1	10	14×15.4
FSE10-3/8	10	PT3/8	41.25	32.1	11	17×18.5
FSE10-1/2	10	PT1/2	44.25	32.1	14	22×24.5
FSE12-1/4	12	PT1/4	44.65	36.9	10	14×15.4
FSE12-3/8	12	PT3/8	45.65	36.9	11	17×18.5
FSE12-1/2	12	PT1/2	48.65	36.9	14	22×24.5